

2L25

2L25

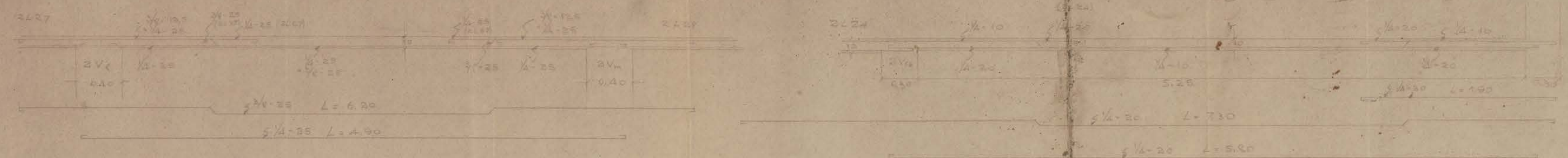

2L42

2L42

2L42

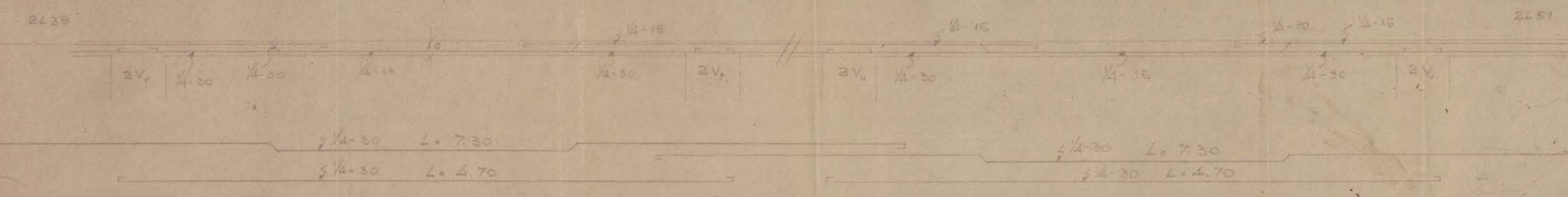

2L44

2L42

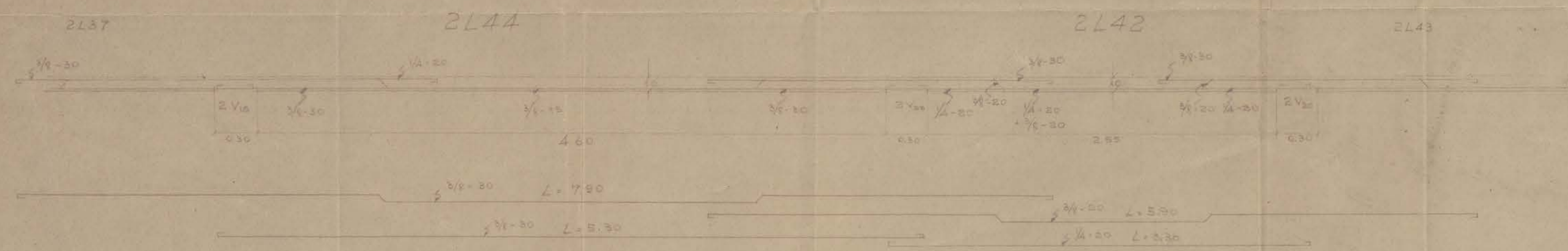

2L44

2L44

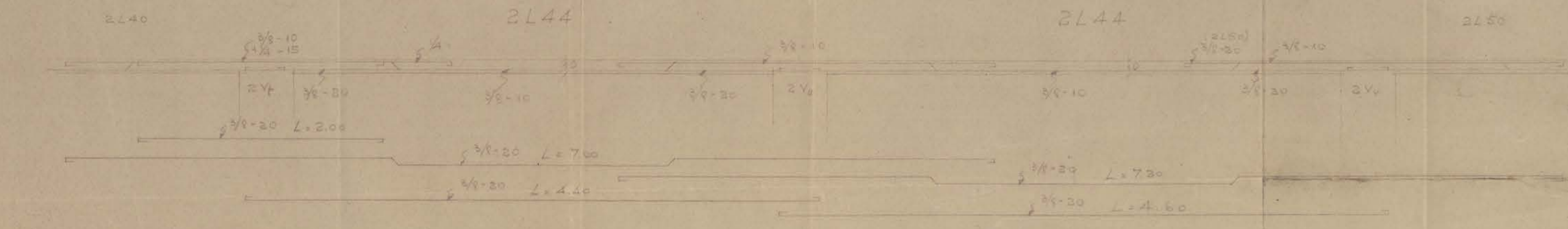

2L46

2L47

2L47

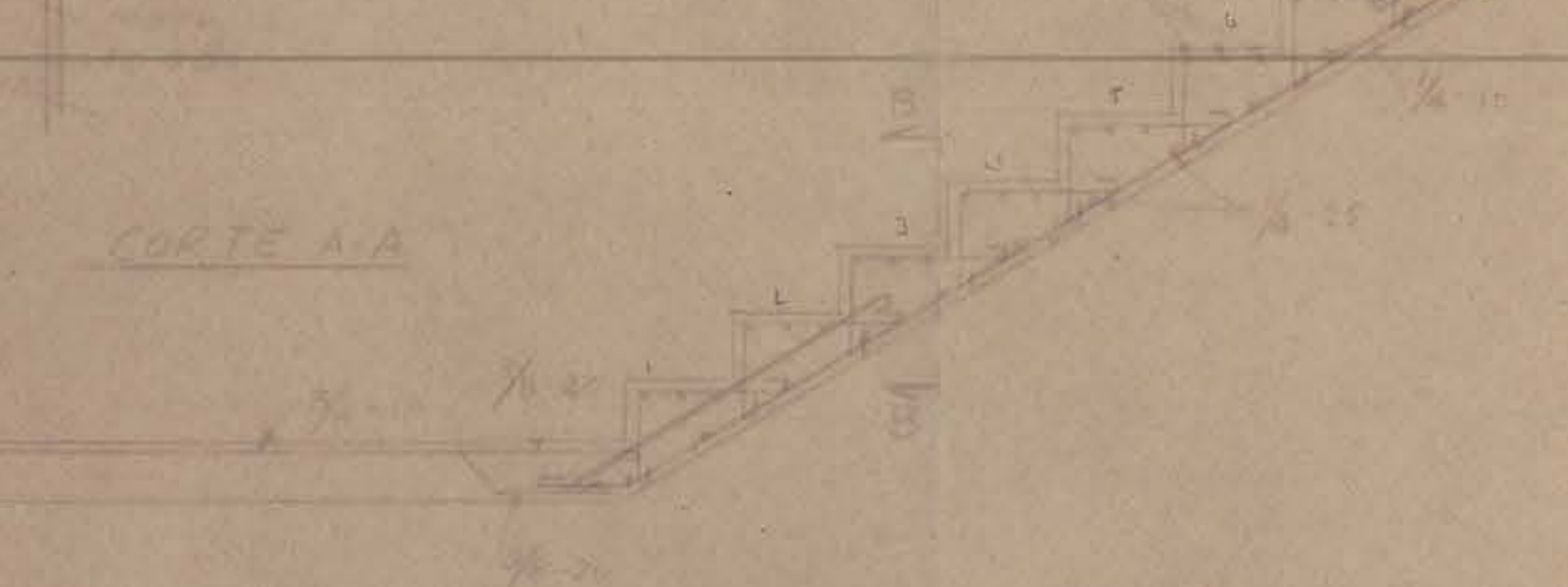
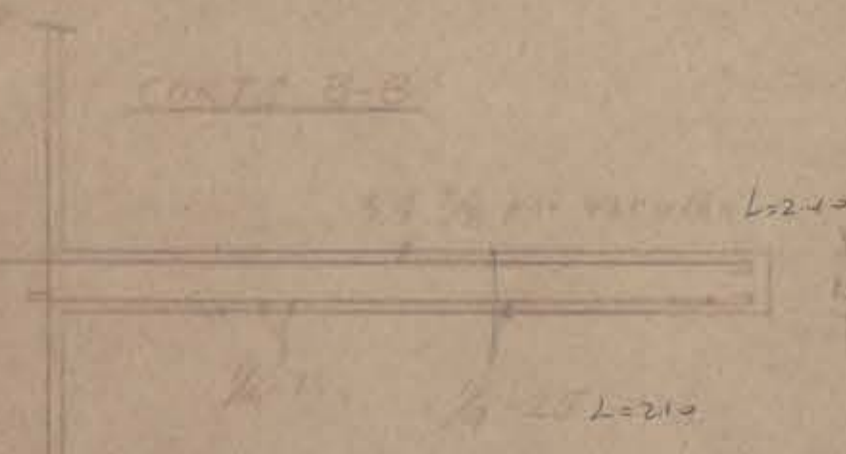
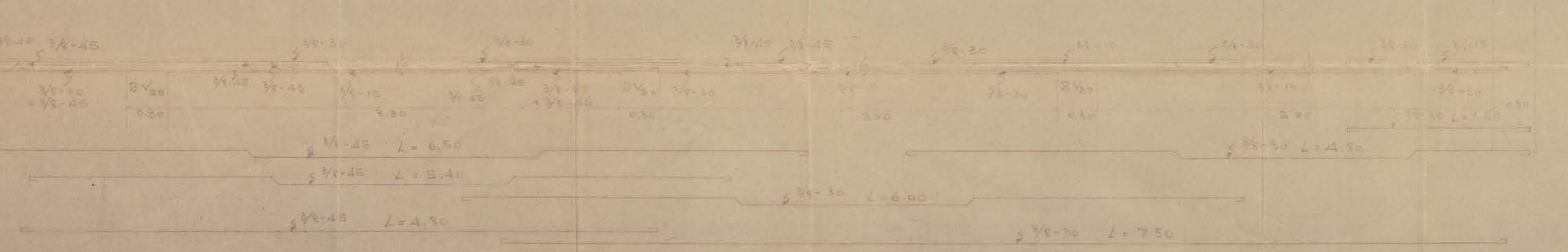

58
 $27 \times 20 \times 0.054$
 $27 \times 20 \times 0.051$
 0.0894

2L46 = 2L47 = 2L47'

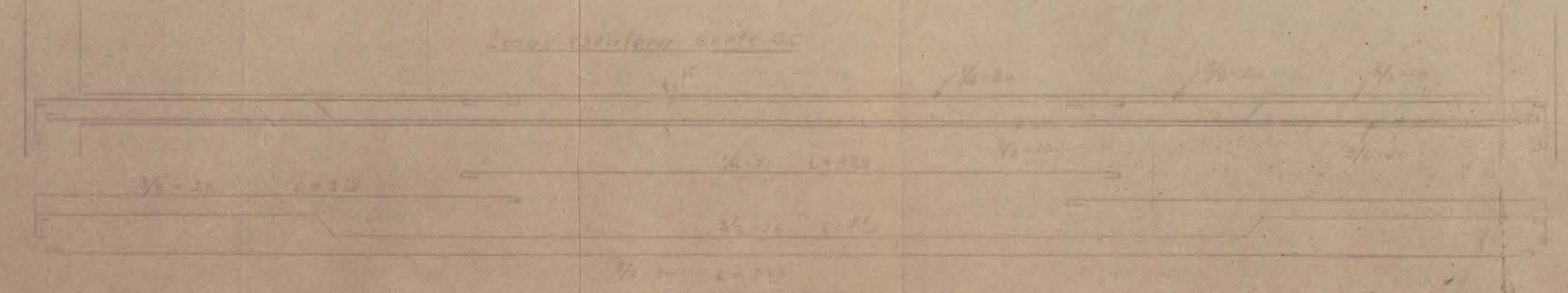
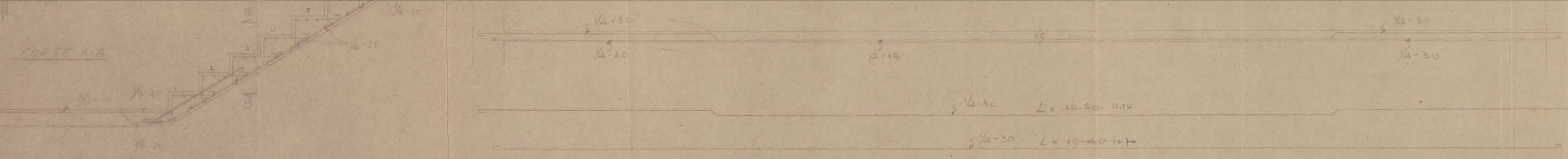

PABELLON CENTRAL ESCUELA DE MEDICINA
 UNIVERSIDAD DE CONCEPCION

PLANOS ESTRUCTURALES **LAMINA N° 18**

Losas entre primero y segundo piso - LADO B

Calculo: *Herrera*
 José Leñiz Cerda - Ing. Civil

Concepción, Marzo de 1947.

